

KRESA MOVE IN BREAKDOWN		
AREA A Administration		
Level One		DATES
	Construction Final Clean	2/20/2025
	Available for Instructional Technology	2/20/2025
	Available for Owner Equipment	2/20/2025
	Available for Owner Furniture	2/20/2025
Level Two		
	Construction Final Clean	1/31/2025
	Available for Instructional Technology	2/3/2025
	Available for Owner Equipment	2/3/2025
	Available for Owner Furniture	2/3/2025
AREA B Automotive		
Level One		DATES
	Construction Final Clean	1/13/2025
	Available for Instructional Technology	2/17/2025
	Available for Owner Equipment	1/15/2025
	Available for Owner Furniture	3/25/2025
Level Two		
	Construction Final Clean	1/10/2025
	Available for Instructional Technology	2/17/2025
	Available for Owner Equipment	2/17/2025
	Available for Owner Furniture	2/17/2025
AREA C Advanced Manufacturing/Welding/Mechatronics		
Level One		DATES
	Construction Final Clean	2/3/2025
	Available for Instructional Technology	3/7/2025
	Available for Owner Equipment (Welding Booths)	1/6/2025
	Available for Owner Furniture	3/7/2025
Level Two		
	Construction Final Clean	3/13/2025
	Available for Instructional Technology	3/13/2025
	Available for Owner Equipment	3/13/2025
	Available for Owner Furniture	3/26/2025
AREA D Construction Trades/Dietary		
Level One		DATES
	Construction Final Clean	1/17/2025
	Available for Instructional Technology	2/17/2025
	Available for Owner Equipment	2/7/2025
	Available for Owner Furniture	2/17/2025
Level Two		
	Construction Final Clean	2/5/2025
	Available for Instructional Technology	2/17/2025
	Available for Owner Equipment	2/7/2025
	Available for Owner Furniture	2/17/2025
AREA E Vet/Healthcare		
Level One		DATES
	Construction Final Clean	2/21/2025
	Available for Instructional Technology	3/3/2025
	Available for Owner Equipment	3/3/2025
	Available for Owner Furniture	3/3/2025
Level Two		
	Construction Final Clean	1/23/2025
	Available for Instructional Technology	1/27/2025
	Available for Owner Equipment	1/30/2025
	Available for Owner Furniture	2/10/2025
AREA F Conference Area		
Level One		DATES
	Construction Final Clean	3/14/2025
	Available for Instructional Technology	3/17/2025
	Available for Owner Equipment	3/17/2025
	Available for Owner Furniture	3/20/2025
Level Two		
	Construction Final Clean	3/14/2025
	Available for Instructional Technology	3/17/2025
	Available for Owner Equipment	3/17/2025
	Available for Owner Furniture	3/20/2025

First Floor

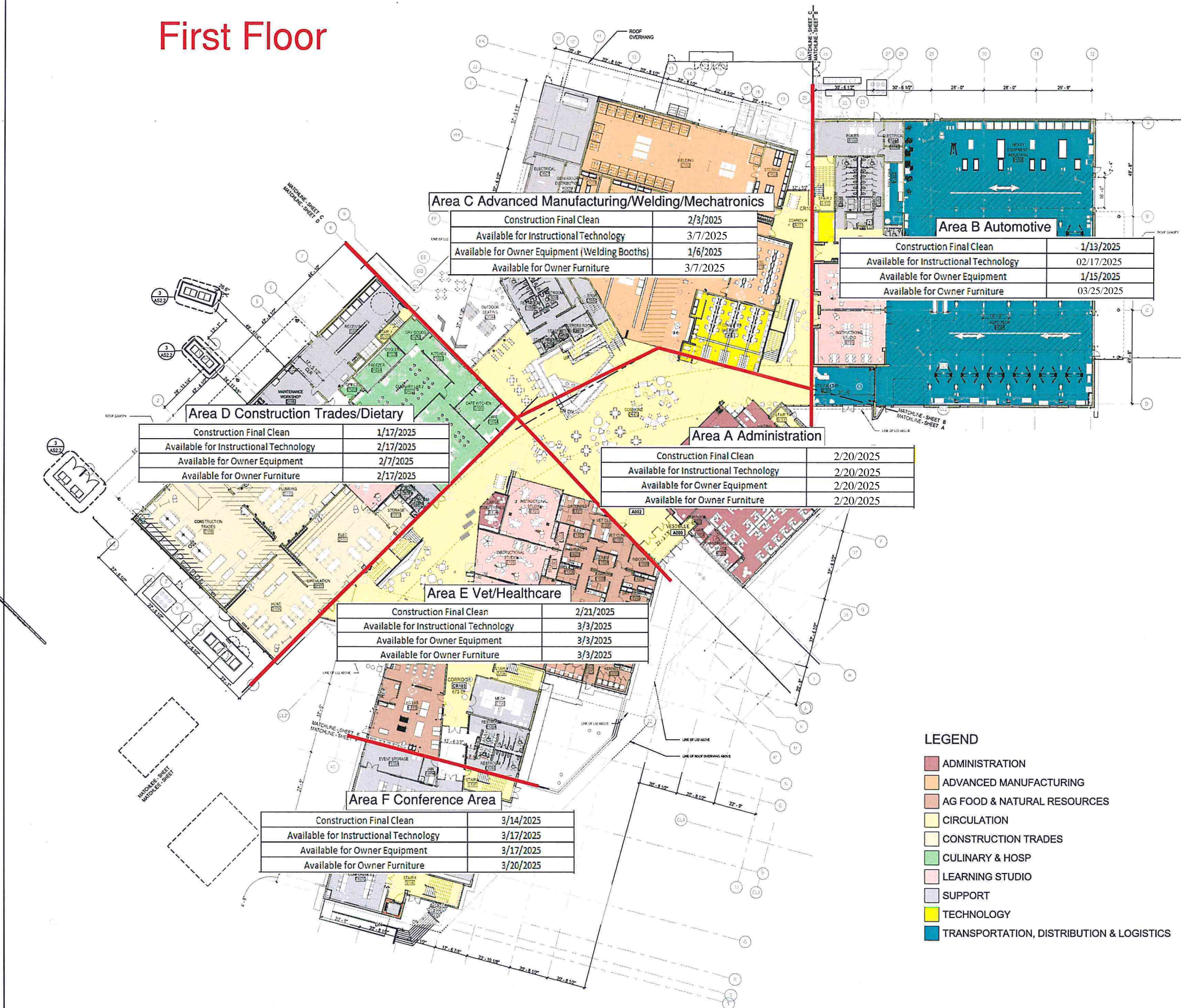

Area C Advanced Manufacturing/Welding/Mechanics

Construction Final Clean	2/3/2025
Available for Instructional Technology	3/7/2025
Available for Owner Equipment (Welding Booths)	1/6/2025
Available for Owner Furniture	3/7/2025

Area B Automotive

Construction Final Clean	1/13/2025
Available for Instructional Technology	02/17/2025
Available for Owner Equipment	1/15/2025
Available for Owner Furniture	03/25/2025

Area D Construction Trades/Dietary

Construction Final Clean	1/17/2025
Available for Instructional Technology	2/17/2025
Available for Owner Equipment	2/7/2025
Available for Owner Furniture	2/17/2025

Area A Administration

Construction Final Clean	2/20/2025
Available for Instructional Technology	2/20/2025
Available for Owner Equipment	2/20/2025
Available for Owner Furniture	2/20/2025

Area E Vet/Healthcare

Construction Final Clean	2/21/2025
Available for Instructional Technology	3/3/2025
Available for Owner Equipment	3/3/2025
Available for Owner Furniture	3/3/2025

Area F Conference Area

Construction Final Clean	3/14/2025
Available for Instructional Technology	3/17/2025
Available for Owner Equipment	3/17/2025
Available for Owner Furniture	3/20/2025

- LEGEND**
- ADMINISTRATION
 - ADVANCED MANUFACTURING
 - AG FOOD & NATURAL RESOURCES
 - CIRCULATION
 - CONSTRUCTION TRADES
 - CULINARY & HOSP
 - LEARNING STUDIO
 - SUPPORT
 - TECHNOLOGY
 - TRANSPORTATION, DISTRIBUTION & LOGISTICS

- GENERAL NOTES**
- GENERAL NOTES APPLY TO ALL SHEETS.
 - DO NOT SCALE DRAWINGS. DIMENSIONS NOTED PREVAIL. NOTIFY ARCHITECT IN CASE OF DISCREPANCY.
 - DIMENSIONS ARE ACTUAL AND ARE TO FINISH FACE OF WALL, FACE OF CONCRETE WALLS, FACE OF CMU WALLS, FACE OF FRAMES, OR CENTERLINE OF COLUMNS, UNLESS NOTED OTHERWISE.
 - INCLUDE ALL OWNER FURNISHED AND INSTALLED ITEMS AND OWNER FURNISHED AND CONTRACTOR-INSTALLED ITEMS IN THE CONSTRUCTION SCHEDULE. AND SHALL COORDINATE WITH THE OWNER TO ACCOMMODATE THESE ITEMS.
 - ARCHITECTURAL FINISH FLOOR ELEVATION 102'-0" EQUALS ACTUAL SITE REFERENCE ELEVATION OF FINISH FLOOR 861'-4".
 - SEE CODE PLANS CP2, CP1.1, CP1.2 FOR LOCATION OF WALLS OF FIRE-RESISTANCE-RATED CONSTRUCTION. ALL WALLS OF FIRE-RESISTANCE-RATED CONSTRUCTION SHALL EXTEND TO UNDERSIDE OF FLOOR OR ROOF DECK ABOVE.
 - ALL PENETRATIONS THROUGH WALLS SHALL BE SEALED WITH PENETRATION FIRE STOPPING MATERIAL AS REQUIRED TO ACHIEVE THE RESPECTIVE FIRE-RESISTANCE RATING AND SMOKE STOPPAGE. SEE SPECIFICATION SECTION 071413.
 - COORDINATE WITH MECHANICAL AND ELECTRICAL CONTRACTORS THE SIZE AND LOCATION OF EQUIPMENT PADS SHOWN ON PLANS.
 - FIRE RESISTANCE-RATED ENCLOSURES AROUND ALL STEEL COLUMNS SHALL BE CONTINUOUS FROM FLOOR TO UNDERSIDE OF FLOOR OR ROOF DECK ABOVE FOR EACH LEVEL.
 - CONSTRUCTION DOCUMENTS ARE COMPLEMENTARY. SEE DRAWING FOR QUANTITIES AND LOCATION OF WORK. SEE SPECIFICATIONS FOR QUALITIES AND CONDITIONS OF WORK.
 - WORK: ALL ASPECTS OF THE WORK AND ITEMS NOT SPECIFICALLY MENTIONED, BUT NECESSARY TO MAKE A COMPLETE WORKING INSTALLATION, SHALL BE INCLUDED AND INDICATED IN THE CONTRACTOR'S BID.
 - NO ASBESTOS OR PCB CONTAINING MATERIALS SHALL BE USED ON THIS PROJECT.
 - HORIZONTAL AND VERTICAL DIMENSIONS ARE MINIMUM DIMENSIONS. CLEARANCES ARE GIVEN TO FINISH SURFACES. GC TO VERIFY ALL CLEARANCES. NOTIFY ARCHITECT IN CASE OF DISCREPANCY.
 - ALL INTERIOR CMU WALLS SHALL BE 8 INCHES NOMINAL THICKNESS, UNLESS NOTED OTHERWISE.
 - WALL TYPES SHALL BE DESIGNATED ON FLOOR PLANS THUS: (COL X XX) SEE SHEET A1.1 FOR WALL TYPES. ALL INTERIOR PARTITIONS ARE WALL TYPE SA.320 UNLESS NOTED OTHERWISE.
 - ALL MASONRY WALLS AND INTERIOR STUD WALLS SHALL EXTEND TO UNDERSIDE OF FLOOR OR ROOF DECK ABOVE UNLESS NOTED OTHERWISE. SEE REFLECTED CEILING PLAN NOTES.
 - PROVISIONS SHALL BE MADE AT ALL FULL HEIGHT NON-BEARING WALLS FOR 1/2" VERTICAL MOVEMENT OF THE BUILDING STRUCTURE WITHOUT TRANSFER OF COMPRESSIVE LOADS TO WALL. FILL IRREGULARITIES BETWEEN TOP OF WALL AND DECK ABOVE WITH MINERAL WOOL INSULATION OR FIRE STOPPING MATERIALS AS REQUIRED TO MEET FIRE RATING OF RESPECTIVE WALLS. SEE DETAILS ON SHEET 20.
 - SEE STRUCTURAL DRAWINGS FOR BRACING OF NON-LOAD BEARING MASONRY WALLS.
 - FURNISH AND INSTALL FIRE-TREATED WOOD BLOCKING OR METAL BACKING PLATE IN METAL STUD PARTITIONS FOR THE PROPER ANCHORAGE OF ALL WALL ATTACHED ITEMS, I.E. TOILET ACCESSORIES, GASWORK, MILLWORK, WALL MOUNTED FIXTURES, MARKER BOARDS, TACK BOARDS, DOOR STOPS, AUDIO VISUAL BRACKETS, AND OTHER WALL ATTACHED ITEMS.
 - GYPSONUM BOARD SURFACES SHALL BE ISOLATED WITH CONTROL JOINTS WHERE SHOWN ON DRAWINGS AND AS DESCRIBED IN THE SPECIFICATIONS.
 - MASONRY CONTROL JOINTS (CJ) AND CONTROL JOINTS ABOVE (CA) SHALL BE LOCATED AS SHOWN ON THE FLOOR PLAN AND BUILDING ELEVATIONS, AND WHERE LARGE PLUMBING VENTS OR RISERS OCCUR IN SINGLE WYTHE MASONRY WALLS, AND WHERE MASONRY WALLS BEARING ON THE CONCRETE FLOOR SLAB ABUT MASONRY WALLS BEARING ON CONCRETE FOOTINGS OR AS INDICATED ON DRAWINGS.
 - "MBO" AND "TBO" INDICATE MARKER BOARDS AND TACK BOARDS ON PLANS. THE LENGTH PRECEDES THE DESIGNATION (EXAMPLE 18" MBO). ALL BOARDS ARE 4'-0" TALL UNLESS NOTED OTHERWISE. SEE WALL ELEVATIONS OR SPECIFICATIONS FOR INDICATING HEIGHT.
 - EXTEND FURRING CHANNELS AND GYPSONUM BOARD UP 4 INCHES ABOVE FINISHED CEILING ON CMU WALLS.
 - SCRIBE GYPSONUM WALL BOARD OF WALLS AND PARTITIONS TO IRREGULARITIES OF DECK ABOVE. SEAL TIGHTLY AROUND ALL PENETRATIONS.
 - SET ALL HINGE SIDE OF DOOR FRAMES 4" FROM ADJACENT WALLS OR FIXED CONSTRUCTION. UNLESS NOTED OTHERWISE, LOCATIONS LESS THAN 4".
 - MARKERBOARDS / TACKBOARDS / FLAT PANEL DISPLAYS ARE TO BE CENTERED ON WALL UNLESS NOTED OTHERWISE.

WIGHTMAN
 BENTON HARBOR
 269.927.0100
 KALAMAZOO
 269.327.3532
 ALLEGAN
 269.873.8465
 ROYAL OAK
 248.791.1371
 www.gowhightman.com

DLR GROUP
 333 WEST WACKER DRIVE, SUITE 450
 CHICAGO, IL 60606
 312.520.1000

IMEG
 1100 WARRENVILLE ROAD
 SUITE 400W
 NAPERVILLE, IL 60563
 www.imegcorp.com
 630.527.2520

CAREER CONNECT CAMPUS
 3500 VANRICK DRIVE
 KALAMAZOO, MI 49001

KALAMAZOO RESA
 INSPIRING EDUCATIONAL EXCELLENCE
 1819 EAST MELHAM ROAD
 PORTAGE, MI 49002

Issued for Bid: 12/29/2022
 Addendum 1: 01/18/2023
 Addendum 2: 01/25/2023
 Addendum 3: 01/27/2023
 Issued for Plan Review: 01/27/2023
 10 Bidder 9: 02/24/2023
 12 Bidder 11: 02/29/2023
 Confirmed Set: 11/30/2023

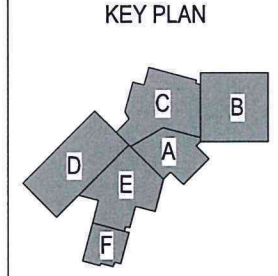

REVISIONS

THE REVISIONS, CORRECTIONS OR OTHER USE OF THIS DRAWING WITHOUT WRITTEN CONSENT IS PROHIBITED. © 2022 WIGHTMAN ASSOCIATES, INC. DATE: 20 DEC 22 SCALE: As Indicated

OVERALL FIRST FLOOR PLAN

JOB NO: 214175
A1.1

Second Floor

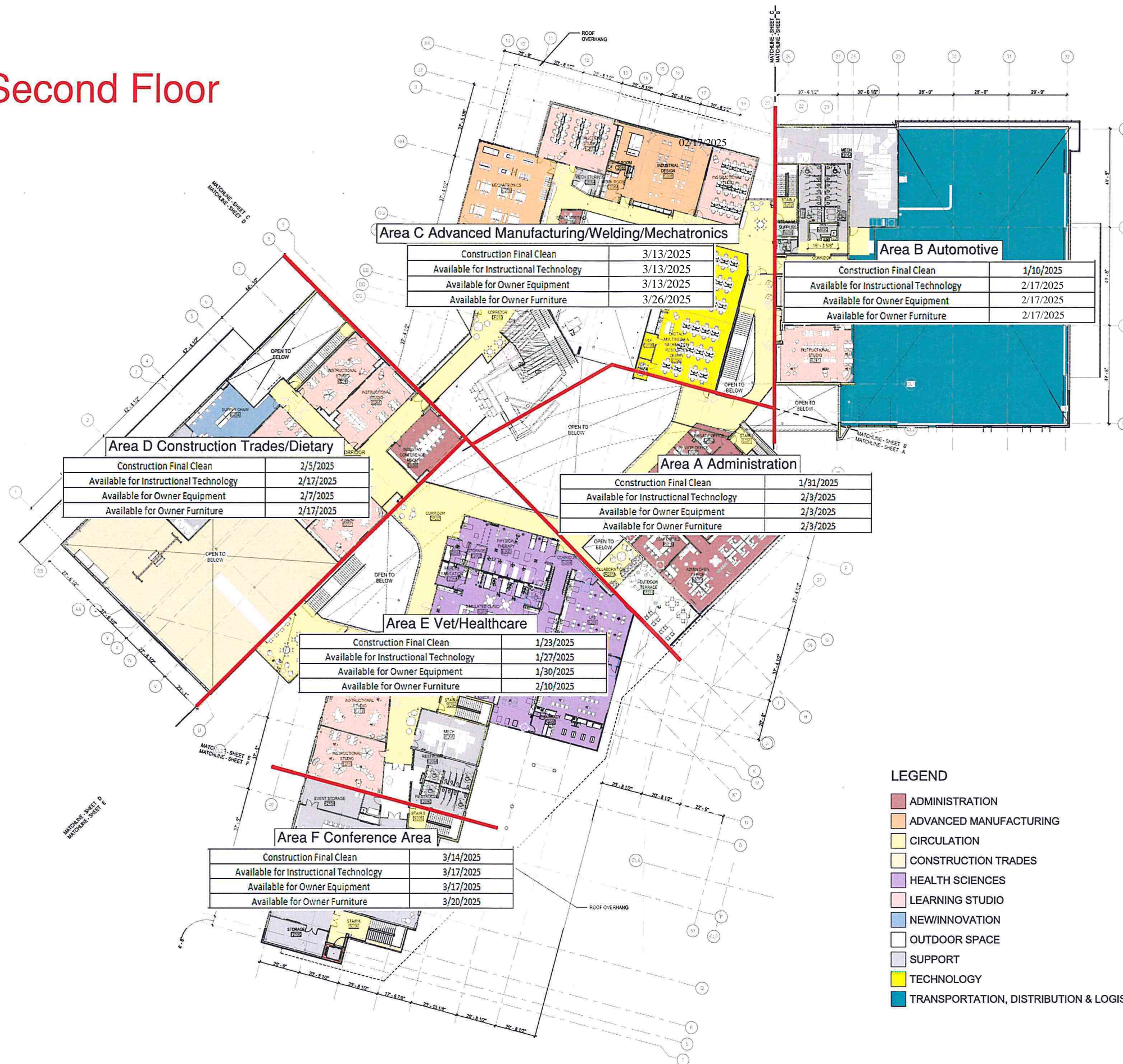

Area C Advanced Manufacturing/Welding/Mechatronics

Construction Final Clean	3/13/2025
Available for Instructional Technology	3/13/2025
Available for Owner Equipment	3/13/2025
Available for Owner Furniture	3/26/2025

Area B Automotive

Construction Final Clean	1/10/2025
Available for Instructional Technology	2/17/2025
Available for Owner Equipment	2/17/2025
Available for Owner Furniture	2/17/2025

Area D Construction Trades/Dietary

Construction Final Clean	2/5/2025
Available for Instructional Technology	2/17/2025
Available for Owner Equipment	2/7/2025
Available for Owner Furniture	2/17/2025

Area A Administration

Construction Final Clean	1/31/2025
Available for Instructional Technology	2/3/2025
Available for Owner Equipment	2/3/2025
Available for Owner Furniture	2/3/2025

Area E Vet/Healthcare

Construction Final Clean	1/23/2025
Available for Instructional Technology	1/27/2025
Available for Owner Equipment	1/30/2025
Available for Owner Furniture	2/10/2025

Area F Conference Area

Construction Final Clean	3/14/2025
Available for Instructional Technology	3/17/2025
Available for Owner Equipment	3/17/2025
Available for Owner Furniture	3/20/2025

LEGEND

- ADMINISTRATION
- ADVANCED MANUFACTURING
- CIRCULATION
- CONSTRUCTION TRADES
- HEALTH SCIENCES
- LEARNING STUDIO
- NEW/INNOVATION
- OUTDOOR SPACE
- SUPPORT
- TECHNOLOGY
- TRANSPORTATION, DISTRIBUTION & LOGISTICS

- GENERAL NOTES**
- GENERAL NOTES APPLY TO ALL SHEETS.
 - DO NOT SCALE DRAWINGS. DIMENSIONS NOTED PREVAIL. NOTIFY ARCHITECT IN CASE OF DISCREPANCY.
 - DIMENSIONS ARE ACTUAL AND ARE TO FINISH FACE OF WALLS, FACE OF CONCRETE WALLS, FACE OF CMU WALLS, FACE OF FRAMES, OR CENTERLINE OF COLUMNS, UNLESS NOTED OTHERWISE.
 - INCLUDE ALL OWNER FURNISHED AND INSTALLED ITEMS AND OWNER FURNISHED AND CONTRACTOR-INSTALLED ITEMS IN THE CONSTRUCTION SCHEDULE. AND SHALL COORDINATE WITH THE OWNER TO ACCOMMODATE THESE ITEMS.
 - ARCHITECTURAL FINISH FLOOR ELEVATION 102'-0" EQUALS ACTUAL SITE REFERENCE ELEVATION OF FINISH FLOOR 861'-4".
 - SEE CODE PLANS CP2.2, CP1.1, CP1.2 FOR LOCATION OF WALLS OF FIRE-RESISTANCE-RATED CONSTRUCTION. ALL WALLS OF FIRE-RESISTANCE-RATED CONSTRUCTION SHALL EXTEND TO UNDERSIDE OF FLOOR OR ROOF DECK ABOVE.
 - ALL PENETRATIONS THROUGH WALLS SHALL BE SEALED WITH PENETRATION FIRE STOPPING MATERIAL AS REQUIRED TO ACHIEVE THE RESPECTIVE FIRE-RESISTANCE RATING AND SMOKE STOPPAGE. SEE SPECIFICATION SECTION 07413.
 - COORDINATE WITH MECHANICAL AND ELECTRICAL CONTRACTORS THE SIZE AND LOCATION OF EQUIPMENT PADS SHOWN ON PLANS.
 - FIRE RESISTANCE-RATED ENCLOSURES AROUND ALL STEEL COLUMNS SHALL BE CONTINUOUS FROM FLOOR TO UNDERSIDE OF FLOOR OR ROOF DECK ABOVE FOR EACH LEVEL.
 - CONSTRUCTION DOCUMENTS ARE COMPLEMENTARY. SEE DRAWING FOR QUANTITIES AND LOCATION OF WORK. SEE SPECIFICATIONS FOR QUALITIES AND CONDITIONS OF WORK.
 - WORK: ALL ASPECTS OF THE WORK AND ITEMS NOT SPECIFICALLY MENTIONED, BUT NECESSARY TO MAKE A COMPLETE WORKING INSTALLATION, SHALL BE INCLUDED AND INDICATED IN THE CONTRACTOR'S BID.
 - NO ASBESTOS OR PCB CONTAINING MATERIALS SHALL BE USED ON THIS PROJECT.
 - HORIZONTAL AND VERTICAL DIMENSIONS ARE MINIMUM DIMENSIONS. CLEARANCES ARE GIVEN TO FINISH SURFACES. GO TO VERIFY ALL CLEARANCES. NOTIFY ARCHITECT IN CASE OF DISCREPANCY.
 - ALL INTERIOR CMU WALLS SHALL BE 8 INCHES NOMINAL THICKNESS, UNLESS NOTED OTHERWISE.
 - WALL TYPES SHALL BE DESIGNATED ON FLOOR PLANS THIS: (SEE X-20) SEE SHEET A8.1 FOR WALL TYPES. ALL INTERIOR PARTITIONS ARE WALL TYPE SA.120 UNLESS NOTED OTHERWISE.
 - ALL MASONRY WALLS AND INTERIOR STUD WALLS SHALL EXTEND TO UNDERSIDE OF FLOOR OR ROOF DECK ABOVE UNLESS NOTED OTHERWISE. SEE REFLECTED CEILING PLAN NOTES.
 - PROVISIONS SHALL BE MADE AT ALL FULL HEIGHT NON-BEARING WALLS FOR 1-INCH VERTICAL MOVEMENT OF THE BUILDING STRUCTURE WITHOUT TRANSFER OF COMPRESSIVE LOADS TO WALL. FILL IRREGULARITIES BETWEEN TOP OF WALL AND DECK ABOVE WITH MINERAL WOOL INSULATION OR FIRE STOPPING MATERIALS AS REQUIRED TO MEET FIRE RATING OF RESPECTIVE WALLS. SEE DETAILS ON SHEET 20.1.
 - SEE STRUCTURAL DRAWINGS FOR BRACING OF NON-LOAD BEARING MASONRY WALLS.
 - FURNISH AND INSTALL FIRE-TREATED WOOD BLOCKING OR METAL BACKING PLATE IN METAL STUD PARTITIONS FOR THE PROPER ANCHORAGE OF ALL WALL ATTACHED ITEMS, IE TOILET ACCESSORIES, CASWORK, MILLWORK, WALL MOUNTED FIXTURES, MARKER BOARDS, TACK BOARDS, DOOR STOPS, AUDIO VISUAL BRACKETS, AND OTHER WALL ATTACHED ITEMS.
 - GYPSON BOARD SURFACES SHALL BE ISOLATED WITH CONTROL JOINTS WHERE SHOWN ON DRAWINGS AND AS DESCRIBED IN THE SPECIFICATIONS.
 - MASONRY CONTROL JOINTS (CJ) AND CONTROL JOINTS ABOVE (CA) SHALL BE LOCATED AS SHOWN ON THE FLOOR PLAN AND BUILDING ELEVATIONS, AND WHERE LARGE PLUMBING VENTS OR RISERS OCCUR IN SINGLE WYTHE MASONRY WALLS, AND WHERE MASONRY WALLS BEARING ON THE CONCRETE FLOOR SLAB ABUT MASONRY WALLS BEARING ON CONCRETE FOOTINGS OR AS INDICATED ON DRAWINGS.
 - "MSB" AND "TBS" INDICATE MARKER BOARDS AND TACK BOARDS ON PLANS. THE LENGTH PRECEDES THE DESIGNATION (EXAMPLE 18" MSB). ALL BOARDS ARE 4'-0" TALL U.N.D. SEE WALL ELEVATIONS OR SPECIFICATIONS FOR MARKING HEIGHT.
 - EXTEND FURNISH CHANNELS AND GYPSON BOARD UP 4 INCHES ABOVE FINISHED CEILING ON CMU WALLS.
 - SCRIBE GYPSON WALL BOARD OF WALLS AND PARTITIONS TO IRREGULARITIES OF DECK ABOVE. SEAL TIGHTLY AROUND ALL PENETRATIONS.
 - SET ALL HINGE SIDE OF DOOR FRAMES 4" FROM ADJACENT WALLS OR FIXED CONSTRUCTION, UNO. NOTIFY ARCHITECT OF LOCATIONS LESS THAN 4".
 - MARKERBOARDS / TACKBOARDS / FLAT PANEL DISPLAYS ARE TO BE CENTERED ON WALL U.N.D.

- KEY NOTES**
- PLAN SHEET NOTE 1
 - PLAN SHEET NOTE 2
 - PLAN SHEET NOTE 3

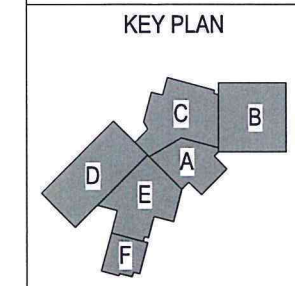

WIGHTMAN
BENTON HARBOR 269.927.0100
KALAMAZOO 269.327.3532
ALLEGAN 269.873.8465
ROYAL OAK 248.791.1371
www.gowhightman.com

DLR GROUP
DLR Group
333 WEST WACKER DRIVE, SUITE 450
CHICAGO, IL 60606
www.dlrgroup.com
312.761.1944

IMEG
1100 WARRENVILLE ROAD
SUITE 400W
NAPERVILLE, IL 60563
www.imegcorp.com
630.527.2320

STATE OF MICHIGAN
KADAN
ARCHITECT
No. 131036813
LICENSED ARCHITECT

PROJECT NAME:
Career Connect Campus

CAREER CONNECT CAMPUS
3500 VANRICK DRIVE
KALAMAZOO, MI 49001

KALAMAZOO RESA
INSPIRING EDUCATIONAL EXCELLENCE
KALAMAZOO RESA
1819 EAST MULHAIR ROAD
PORTAGE, MI 49602

Issued for Bid 12/09/22
3 Addendum 01/16/23
Issued for Plan 01/17/23
Revised
6 Bulletin 03/12/23
20 Bulletin 09/15/23
Contract Set 11/30/23

REVISIONS

THESE PRODUCTION COPIES OR THEIR USE OR THE DRAWING WITHOUT WRITTEN CONSENT IS PROHIBITED.
© 2023 WIGHTMAN ASSOCIATES, PC
DATE: 20 DEC 22
SCALE: As Indicated

OVERALL SECOND FLOOR
JOB NO: 214175
A1.2